



Benetti Classic 132 | 2019

New yacht

Price in Europe

18 800 000 €

VAT not paid

Short description

Specifications

Length overall	40.24 m
Beam overall	8.18 m
Draft	2.10 m
Material	GRP
Cabines	5 + 4
Head compartments	5 + 4
Engine	2 x MTU 12V 2000 M72 1450 hp
Fuel capacity	45000 l
Water capacity	7200 l
Max speed	15.50 knots
Cruising speed	14.50 knots
Range	3500 miles



Экстерьер Benetti Supreme 132



Экстерьер Benetti Supreme 132



Экстерьер Benetti Supreme 132



Кормовая часть верхней палубы



Салон на главной палубе



Салон на главной палубе



Обеденная зона в салоне на главной палубе



Каюта владельца



Каюта владельца



Балкон в каюте владельца



Балкон в каюте владельца



VIP каюта

Общий вид



Сандек

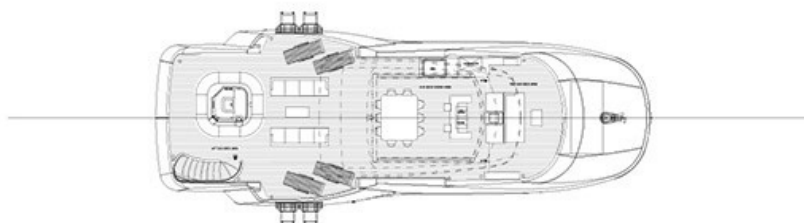

Верхняя палуба

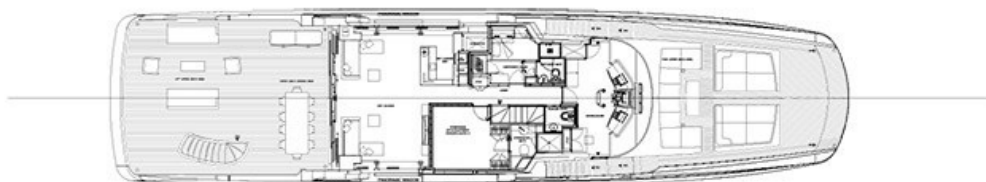

Technical characteristics

Length overall	40.24 m	Range	3500 nm
Beam overall	8.18 m	Fuel capacity	45000 l
Draft	2.10 m	Water capacity	7200 l
Engine	2 x MTU 12V 2000 M72 1450 hp	Cabins	5 + 4
Max speed	15.50 knots	Berths	10 + 7
Cruising speed	14.50 knots	Head compartments	5 + 4
		Material	GRP
		Interior design	Francois Zuretti
		Builder	Stefano Righini

Regulations UNI ISO 8666

The levels of performance described apply to a standard craft (with standard equipment installed) with clean hull, propeller and rudders. Moreover, it is specified that such levels of performance were achieved under favourable sea and wind conditions (1 on the Beaufort scale and 1 on the Douglas scale); in the case of diverse or less favourable sea conditions performance levels may vary considerably.

EC Approved

Azimut reserves the right to modify the specification and characteristics of its vessels at any time.